



Hive Road

Bushey

Asking price £675,000

Davidson Frost-Wellings are delighted to offer to the market this immaculately presented, four bedroom penthouse flat with two balconies and stunning views.

The property is set in one of Bushey Heath's most sought-after locations and comprises light and airy rooms throughout. a spacious reception room incorporating a lounge/diner with a large balcony, floor to ceiling, glass sliding doors and a feature fireplace. There are also two bathrooms (one en suite), a fitted eat-in kitchen with balcony overlooking landscaped communal gardens, and a garage. The owners have recently refurbished the flat to a very high standard. Available chain free.

Leasehold in excess of 135 years.

Ground Rent nil.

Service Charge of approximately £3000 per year.

Hertsmere Council Tax Band F.

- Four Bedrooms
- Two Bathrooms
- Spacious Balcony with Gorgeous Views
- Garage and Parking
- Superb Condition
- Communal Garden

Viewing

Please contact our Davidson Frost-Wellings Office on 020 8954 8806 if you wish to arrange a viewing appointment for this property or require further information.



Floor Plan

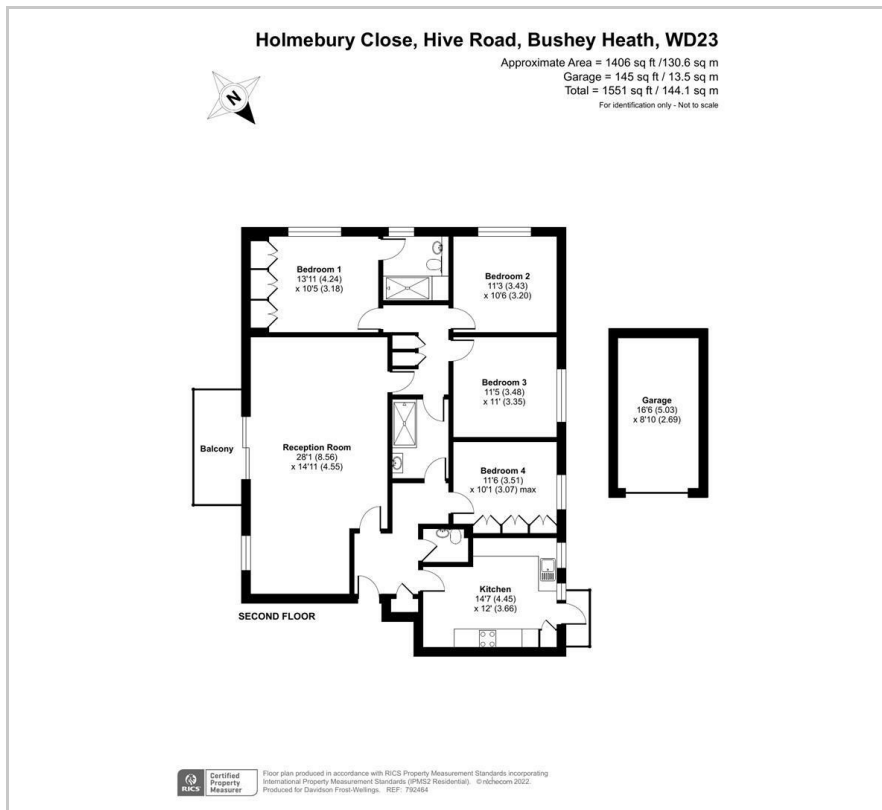

Area Map

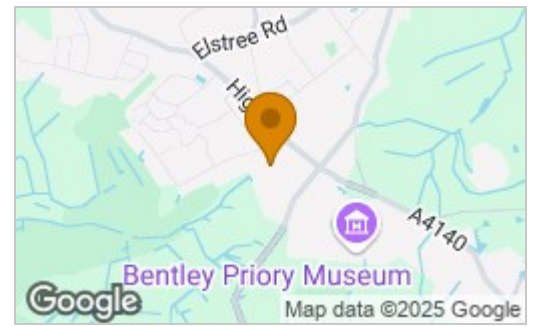

Energy Efficiency Rating

	Current	Potential
<i>Very energy efficient - lower running costs</i>		
(92 plus) A		
(81-91) B		
(69-80) C		76
(55-68) D		
(39-54) E		
(21-38) F	21	
(1-20) G		
<i>Not energy efficient - higher running costs</i>		
England & Wales	EU Directive 2002/91/EC	



These particulars, whilst believed to be accurate are set out as a general outline only for guidance and do not constitute any part of an offer or contract. Intending purchasers should not rely on them as statements of representation of fact, but must satisfy themselves by inspection or otherwise as to their accuracy. No person in this firm's employment has the authority to make or give any representation or warranty in respect of the property.